



### FEATURES

- ▶ High strength to weight ratio.
- ▶ Many shapes and sizes to suit any application.
- ▶ Coined shackle pin head available with hole for seizing wire.

### MATERIALS

- ▶ Grade 316 stainless steel bodies and pins.

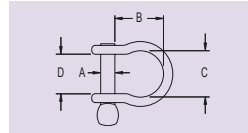
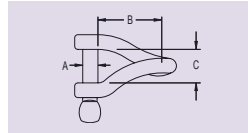
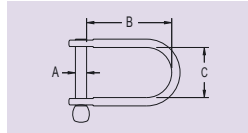
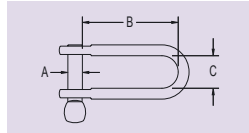
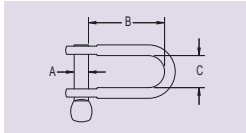

PRODUCT No.	A		B		C		D		(U.D.L.)* B.L.		(P.L.)* B.L.		WEIGHT	
	mm	(in.)	mm	(in.)	mm	(in.)	mm	(in.)	kg	(lb)	kg	(lb)	g	(oz)
<b>Standard Dee</b>														
RF1851	3.2	(1/8)	12	(15/32)	9	(11/32)	-	-	550	(1210)	280	(620)	2	(0.1)
RF1806	4	(5/32)	15	(19/32)	10	(13/32)	-	-	800	(1760)	600	(1320)	5	(0.2)
RF616	4.8	(3/16)	18	(23/32)	11	(7/16)	-	-	1400	(3090)	800	(1760)	15	(0.5)
RF617	6.4	(1/4)	22	(7/8)	14	(9/16)	-	-	2300	(5070)	1400	(3090)	25	(0.9)
RF618	7.9	(5/16)	29	(1 5/32)	17	(21/32)	-	-	3600	(7940)	2700	(5950)	50	(1.8)
RF619**	9.5	(3/8)	40	(1 9/16)	18	(23/32)	-	-	5400	(11900)	3600	(7940)	80	(2.8)
RF620**	12.7	(1/2)	41	(1 5/8)	19	(3/4)	-	-	7700	(16980)	7500	(16530)	130	(4.6)
RF1035***	15.9	(5/8)	45	(1 25/32)	26	(1 1/32)	-	-	14000	(30860)	11000	(24250)	280	(9.9)
<b>Long Dee</b>														
RF621	4	(5/32)	26	(1 1/32)	10	(13/32)	-	-	800	(1760)	600	(1320)	10	(0.4)
RF622	4.8	(3/16)	31	(1 7/32)	12	(15/32)	-	-	1400	(3090)	800	(1760)	15	(0.5)
RF623	6.4	(1/4)	43	(1 11/16)	14	(9/16)	-	-	2300	(5070)	1400	(3090)	30	(1.1)
RF624	7.9	(5/16)	54	(2 1/8)	17	(21/32)	-	-	3600	(7940)	2700	(5950)	60	(2.1)
RF625**	9.5	(3/8)	59	(2 5/16)	18	(23/32)	-	-	5800	(12790)	4500	(9920)	90	(3.2)
RF626**	12.7	(1/2)	70	(2 3/4)	19	(3/4)	-	-	7700	(16980)	7500	(16530)	155	(5.5)
<b>Wide Dee</b>														
RF1850S	3.2	(1/8)	12	(15/32)	9	(11/32)	-	-	550	(1210)	280	(620)	2	(0.1)
RF1852	4.8	(3/16)	28	(1 3/32)	21	(13/16)	-	-	1400	(3090)	700	(1540)	15	(0.5)
RF1853	6.4	(1/4)	39	(1 17/32)	30	(1 3/16)	-	-	2300	(5070)	1100	(2430)	26	(0.9)
RF639	7.9	(5/16)	51	(2)	28	(1 3/32)	-	-	3600	(7940)	2300	(5070)	70	(2.5)
RF640	9.5	(3/8)	55	(2 5/32)	29	(1 5/32)	-	-	5800	(12790)	4000	(8820)	95	(3.4)
RF641**	12.7	(1/2)	66	(2 19/32)	31	(1 7/32)	-	-	7700	(16980)	5500	(12130)	170	(6.0)
<b>Twisted</b>														
RF627	4	(5/32)	22	(7/8)	10	(13/32)	-	-	800	(1760)	600	(1320)	5	(0.2)
RF628	4.8	(3/16)	27	(1 1/16)	10	(13/32)	-	-	1400	(3090)	800	(1760)	15	(0.5)
RF629	6.4	(1/4)	39	(1 17/32)	14	(9/16)	-	-	2300	(5070)	1400	(3090)	30	(1.1)
RF630	7.9	(5/16)	48	(1 29/32)	16	(5/8)	-	-	3600	(7940)	2700	(5950)	65	(2.3)
RF631**	9.5	(3/8)	53	(2 3/32)	16	(5/8)	-	-	5800	(12790)	4500	(9920)	90	(3.2)
RF632**	12.7	(1/2)	64	(2 17/32)	19	(3/4)	-	-	7700	(16980)	7500	(16530)	165	(5.8)
<b>Bow</b>														
RF613S****	3	(1/8)	13	(1/2)	9	(11/32)	6.4	(1/4)	550	(1210)	280	(620)	3	(0.1)
RF633	4	(5/32)	14	(9/16)	13	(1/2)	10	(13/32)	800	(1760)	600	(1320)	5	(0.2)
RF634	4.8	(3/16)	17	(21/32)	14	(9/16)	11	(7/16)	1400	(3090)	800	(1760)	10	(0.4)
RF635	6.4	(1/4)	21	(13/16)	19	(3/4)	16	(5/8)	2300	(5070)	1400	(3090)	20	(0.7)
RF636	7.9	(5/16)	27	(1 1/16)	22	(7/8)	16	(5/8)	3600	(7940)	2700	(5950)	45	(1.6)
RF638**	7.9	(5/16)	27	(1 1/16)	22	(7/8)	16	(5/8)	3600	(7940)	2700	(5950)	45	(1.6)
RF637**	9.5	(3/8)	51	(2)	36	(13/32)	20	(25/32)	5800	(12790)	4500	(9920)	90	(3.2)

\* (P.L.) B.L. – The "Point Load" breaking load of the shackle; the load is only applied at the centre or one side of the shackle pin.

(U.D.L.) B.L. – The "Uniformly Distributed Load" breaking load of the shackle; the load is applied across the full span of the shackle pin.

\*\* Shackle pins drilled for seizing wire. \*\*\*RF1035 features 20.7mm (13/16") A/F hexagonal pin head. \*\*\*\*RF613S has a slotted head.

American Rigging Supply, Inc.



### FEATURES

- ▶ Halyard shackles have a lever action for easy opening and closing, with a keyed pin for positive locking.
- ▶ Slotted shackle pins are low profile to prevent snagging on ropes etc.

### MATERIALS

- ▶ Grade 316 stainless steel bodies and pins.

- ▶ Lightweight clevis pin shackles use a split ring for security.
- ▶ Shackle keys are available to suit both coined and slotted pins.

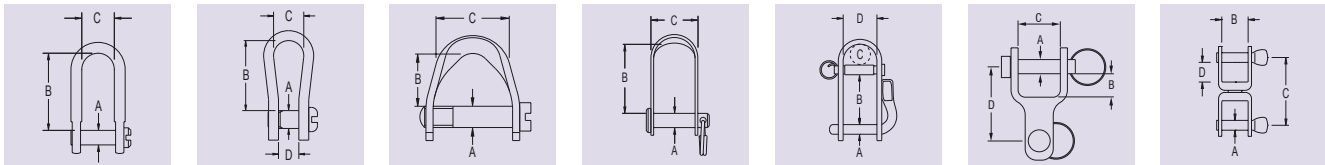

PRODUCT No.	A		B		C		D		(U.D.L.)* B.L.		(P.L.)* B.L.		WEIGHT	
	mm	(in.)	mm	(in.)	mm	(in.)	mm	(in.)	kg	(lb)	kg	(lb)	g	(oz)
<b>Standard Slotted Pin</b>														
RF615	4	(5/32)	15	(19/32)	10	(13/32)	-	-	800	(1760)	600	(1320)	5	(0.2)
RF615A	4	(5/32)	13	(1/2)	9	(3/8)	-	-	1000	(2200)	800	(1760)	7	(0.2)
RF150	4.7	(3/16)	18	(23/32)	10	(13/32)	-	-	1400	(3090)	800	(1760)	10	(0.4)
RF707S	4.8	(3/16)	17	(21/32)	13	(1/2)	-	-	1200	(2650)	700	(1540)	10	(0.4)
RF151	6.4	(1/4)	22	(7/8)	14	(9/16)	-	-	2300	(5070)	1400	(3090)	20	(0.7)
RF152	7.9	(3/16)	29	(1 5/32)	17	(21/32)	-	-	3600	(7940)	2700	(5950)	45	(1.6)
<b>Special Slotted Pin</b>														
RF614	4.8	(3/16)	18	(23/32)	9.8	(3/8)	5	(3/16)	1400	(3090)	1400	(3090)	5	(0.2)
RF806S	4.8	(3/16)	11	(7/16)	16	(5/8)	-	-	1100	(2430)	-	-	10	(0.4)
<b>Lightweight Clevis Pin</b>														
RF801	4.8	(3/16)	7.4	(9/32)	7	(9/32)	-	-	480	(1060)	320	(710)	3	(0.1)
RF807	4.8	(35/16)	20	(25/32)	14	(9/16)	-	-	700	(1540)	-	-	10	(0.4)
RF802	4.9	(3/16)	9.3	(3/8)	8.8	(11/32)	-	-	660	(1460)	440	(970)	5	(0.2)
RF803	5.9	(7/32)	12.2	(15/32)	11.3	(7/16)	-	-	900	(1980)	600	(1320)	10	(0.4)
RF804	5.9	(7/32)	13.3	(17/32)	13.3	(17/32)	-	-	1480	(3260)	990	(2180)	12	(0.4)
RF805	7.9	(5/16)	16.7	(21/32)	17.6	(11/16)	-	-	1800	(3970)	1200	(2650)	25	(0.9)
<b>Halyard</b>														
RF1032	4.8	(3/16)	22	(7/8)	10	(13/32)	15	(19/32)	1200	(2650)	900	(1980)	30	(1.1)
RF1033	6.4	(1/4)	32	(1 1/4)	13	(1/2)	19	(3/4)	2100	(4630)	1500	(3310)	55	(1.9)
RF1034	7.9	(5/16)	39	(1 17/32)	18	(23/32)	20	(25/32)	2700	(5950)	2200	(4850)	90	(3.2)
<b>Swivel</b>														
RF576	4.0	(5/32)	10	(13/32)	22	(7/8)	6.0	(15/64)	500	(1100)	350	(770)	10	(0.4)
RF120	4.8	(3/16)	12	(15/32)	32	(1 1/4)	8.7	(11/32)	650	(1430)	650	(1430)	20	(0.7)
RF173	6.4	(1/4)	15	(19/32)	42	(1 5/8)	11.9	(15/32)	1100	(2420)	700	(1540)	40	(1.4)
RF75	7.9	(5/16)	17	(21/32)	60	(2 3/8)	15.8	(5/8)	2100	(4620)	-	-	15	(0.5)
<b>Two Way Link</b>														
RF815	5	(3/16)	5.2	(7/32)	10	(13/32)	5.5	(7/32)	1100	(2430)	900	(1980)	14	(0.5)
RF816	6	(1/4)	6.7	(1/4)	12.2	(15/32)	7.0	(9/32)	1200	(2650)	1000	(2200)	21	(0.7)
<b>Shackle Keys</b>														
RF1320BLU	Heavy duty shackle key, multi-purpose tool. Suits coined head shackle pins. Features sockets for 1/6" and 1/4" plain and nylock nuts. Screwdriver, ideal for tightening small drain plugs. Blue plastic grip												90	(3.2)
RF1320R	As per RF1320BLU, but RED plastic												90	(3.2)
RF1321	Micro shackle key. Suits coined head shackle pins up to 6mm (1/4") diam. Screwdriver. Bottle opener, Lanyard included												11	(0.4)

\* (U.D.L.) B.L. – The "Uniformly Distributed Load" breaking load of the shackle; the load is applied across the full span of the shackle pin.

(P.L.) B.L. – The "Point Load" breaking load of the shackle; the load is only applied at the centre or one side of the shackle pin.

\*\* RF75 swivel shackle has ball bearings

American Rigging Supply, Inc.

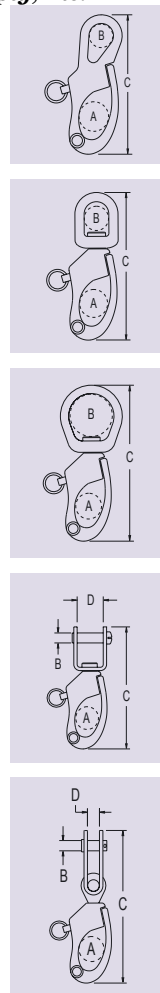

### FEATURES

- ▶ Fixed or swivel heads.
- ▶ Heavy duty plunger springs and precision components ensure dependable service.
- ▶ Body and hasp profiles are designed for easy clearance of lines and fittings when released.
- ▶ Stainless steel is used throughout for excellent corrosion resistance.
- ▶ High strength to weight ratio.
- ▶ Split ring on plunger pin is spot welded for security.
- ▶ A lanyard can be attached to the plunger pin for easy opening.
- ▶ RF6170 is a snap shackle block adapter with a 5mm (3/16") pin.

### MATERIALS

- ▶ Grade 15-5PH investment cast stainless steel body and hasp.
- ▶ Grade 316 stainless steel plunger pin and spring.

PRODUCT No.	HEAD TYPE	A		B		C		D		M.W.L.		B.L.		WEIGHT	
		mm	(in.)	mm	(in.)	mm	(in.)	mm	(in.)	kg	(lb)	kg	(lb)	g	(oz)
<b>Series 100</b>															
RF6100	Fixed bail	16	(5/8)	15	(19/32)	66	(2 19/32)	-	-	1000	(2200)	2000	(4410)	43	(1.5)
RF6110	Small swivel bail	16	(5/8)	10	(13/32)	69	(2 23/32)	-	-	850	(1870)	1700	(3750)	50	(1.8)
RF6120	Large swivel bail	16	(5/8)	13	(1/2)	73	(2 7/8)	-	-	750	(1650)	1500	(3310)	57	(2.0)
RF6130	Swivel shackle	16	(5/8)	6.4	(1/4)	72	(2 27/32)	13	(1/2)	750	(1650)	1500	(3310)	64	(2.3)
RF6170	Block head adapter	16	(5/8)	5	(3/16)	60	(2 3/8)	-	-	500	(1100)	1135	(2500)	49	(1.7)
<b>Series 200</b>															
RF6200	Fixed bail	16	(5/8)	19	(3/4)	85	(3 11/32)	-	-	900	(1980)	1800	(3970)	100	(3.5)
RF6210	Small swivel bail	16	(5/8)	16	(5/8)	92	(3 5/8)	-	-	1600	(3530)	3200	(7050)	113	(4.0)
RF6220	Large swivel bail	16	(5/8)	25	(1)	101	(3 31/32)	-	-	1100	(2430)	2200	(4850)	120	(4.2)
RF6230	Swivel shackle	16	(5/8)	7.9	(5/16)	95	(3 3/4)	19	(3/4)	1100	(2430)	2200	(4850)	120	(4.2)
RF6240	Swivel shackle	16	(5/8)	7.9	(5/16)	100	(3 15/16)	22	(7/8)	1100	(2430)	2200	(4850)	135	(4.8)
<b>Series 300</b>															
RF6300	Fixed bail	26	(1 1/32)	19	(3/4)	100	(3 15/16)	-	-	2000	(4410)	4000	(8820)	155	(5.5)
RF6310	Small swivel bail	26	(1 1/32)	16	(5/8)	110	(4 11/32)	-	-	1800	(3970)	3600	(7940)	142	(5.0)
RF6320	Large swivel bail	26	(1 1/32)	26	(1 1/32)	122	(4 3/4)	-	-	1350	(2980)	2700	(5950)	170	(6.0)
RF6350	Swivel toggle	26	(1 1/32)	9.5	(3/8)	132	(5 3/16)	13	(1/2)	1500	(3310)	3000	(6610)	241	(8.5)

## TRUNNION ARTICULATION

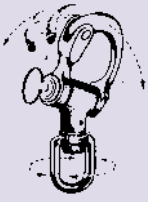

RF6111



RF6121



RF6171



RF6211

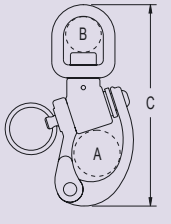

RF6311



RF6321



RF6411



RF6511

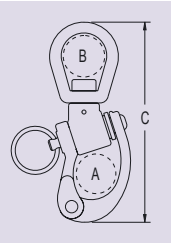

### FEATURES

- ▶ Trunnion swivel head allows both 360° rotation and sided to side articulation.
- ▶ Small and large bail versions.
- ▶ RF6171 is a snap shackle block adapter with a 5mm (3/16") pin.

### MATERIALS

- ▶ Grade 15-5PH investment cast stainless steel body and hasp.
- ▶ Stainless steel plunger pin and spring.

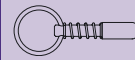

### REPLACEMENT PLUNGER PIN KITS

RF6160	Suits RF6110, RF6120, RF6130, RF6170
RF6161	Suits RF6100, RF6111, RF6121, RF6171
RF6260	Suits RF6210, RF6220, RF6230, RF6240
RF6261	Suits RF6211
RF6360	Suits RF6310, RF6311, RF6320, RF6321, RF6350
RF6461	Suits RF6411
RF6561	Suits RF6511

PRODUCT No.	HEAD TYPE	A		B		C		M.W.L.		B.L.		WEIGHT	
		mm	(in.)	mm	(in.)	mm	(in.)	kg	(lb)	kg	(lb)	g	(oz)
<b>Series 100</b>													
RF6111	Small swivel bail	16	(5/8)	10	(13/32)	70	(2 3/4)	750	(1650)	1500	(3310)	57	(2.0)
RF6121	Large swivel bail	16	(5/8)	12	(15/32)	75	(2 31/32)	750	(1650)	1500	(3310)	64	(2.3)
RF6171	Block head adapter	16	(5/8)	-	-	60	(2 3/8)	500	(1100)	1000	(2200)	62	(2.2)
<b>Series 200</b>													
RF6211	Small swivel bail	20	(25/32)	16	(5/8)	100	(3 15/16)	1500	(3310)	3000	(6610)	128	(4.5)
<b>Series 300</b>													
RF6311	Small swivel bail	26	(1 1/32)	15	(19/32)	110	(4 11/32)	1500	(3310)	3000	(6610)	170	(6.0)
RF6321	Large swivel bail	26	(1 1/32)	26	(1 1/32)	122	(4 13/16)	1350	(2980)	2700	(5950)	198	(7.0)
<b>Series 400</b>													
RF6411	Small swivel bail	32	(1 1/4)	25	(1)	137	(5 13/32)	3000	(6610)	6000	(13230)	369	(13)
<b>Series 500</b>													
RF6511	Small swivel bail	36	(1 13/32)	22	(7/8)	150	(5 29/32)	3750	(8270)	7500	(16530)	454	(16)