

# WIRE & DYFORM RIGGING SYSTEMS

## SWAGE TERMINALS

Swage terminals are principally used to terminate 1 x 19 stainless steel wire strand and Dyform. They may also be used on flexible wire ropes with a wire core. All swaging machines work by firmly squeezing the material of the terminal into the interstices of the wire. In the Wire Teknik roller swaging machine (detailed on page 29) the terminal is drawn through passive rollers. All types of machine can produce a swage as strong as the wire when adjusted and used correctly. Other acceptable methods of swaging include hydraulic presses with suitable die sets and rotary hammer swaging.

Gibb swage terminals are manufactured from 316 stainless steel. Lesser grades do not have sufficient corrosion resistance, particularly in tropical waters. Material hardness is controlled to ensure ease of swaging. Gibb swage terminal dimensions comply with the US military standard that has been used exclusively for many years in the USA, UK and Australia. All terminals are compatible with current UK and US practice as regards pin sizes and fork widths.

Gibb swage terminals are available in several different forms.

**EYE TERMINALS** are widely used to attach to most tangs and to rigging screw forks. The traditionally styled 546 eye terminals are machined from solid bar.

**FORK TERMINALS** are not as common, but are useful in split backstays, for example, or wherever a single link plate is fitted.

**STUD TERMINALS** are the most commonly used turnbuckle to wire connections.

**TOGGLE FORK TERMINALS** can be selected where the wire terminal is subjected to fluctuating side loads and fatigue, such as running backstays and lifelines.

We are pleased to quote for cable sizes outside the range detailed here.

### EYE SWAGE TERMINAL

PART#	WIRE Ø	B	C	Ø D	E	Ø F
	mm	mm	mm	mm	mm	mm
METRIC DIMENSIONS						
546-2.5-1/4	2.5	6.5	11.5	6.5	5.5	13.0
546-3-1/4	3	7.0	11.0	6.5	5.5	13.0
546-4-5/16	4	8.2	13.0	8.1	6.7	16.0
546-5-3/8	5	11.0	17.0	9.7	8.0	19.0
546-6-7/16	6	12.5	19.5	11.3	9.5	23.0
546-7-1/2	7	14.5	22.5	13.0	10.8	27.0
546-8-1/2	8	16.0	23.0	13.0	12.5	27.0
546-8-5/8	8	18.0	25.0	16.2	12.5	33.0
546-10-5/8	10	18.0	28.0	16.2	13.5	33.0
546-12-3/4	12	21.0	39.0	19.2	18.0	40.0
546-14-7/8	14	25.0	41.0	22.5	21.0	47.5
546-16-1	16	27.5	44.5	25.7	24.0	54.0
546-19-11/8	19	30.0	50.0	29.0	25.7	57.0
546-22-11/4	22	38.0	55.0	32.0	33.0	63.0
546-26-11/4	26	42.0	61.0	35.0	31.3	69.0
USA - IMPERIAL DIMENSIONS						
	ins	ins	ins	ins	ins	ins
N546-0308	3/32	0.256	0.453	0.256	0.217	0.512
N546-0408	1/8	0.256	0.453	0.256	0.217	0.512
N546-0510	5/32	0.323	0.512	0.319	0.264	0.630
N546-0612	3/16	0.394	0.669	0.382	0.315	0.748
N546-0716	7/32	0.492	0.768	0.445	0.374	0.906
N546-0816	1/4	0.531	0.945	0.512	0.374	1.024
N546-0916	9/32	0.571	0.886	0.512	0.425	1.063
N546-1016	5/16	0.630	0.906	0.512	0.492	1.063
N546-1020	5/16	0.709	0.984	0.638	0.492	1.299
N546-1220	3/8	0.709	1.102	0.638	0.531	1.299
N546-1424	7/16	0.827	1.535	0.756	0.709	1.575
N546-1624	1/2	0.827	1.535	0.756	0.709	1.575
N546-1828	9/16	0.984	1.614	0.886	0.827	1.870
N546-2032	5/8	1.083	1.752	1.012	0.945	2.126
N546-2436	3/4	1.181	1.969	1.142	1.012	2.244
N546-2840	7/8	1.496	2.165	1.300	1.126	2.480
N546-3244	1	1.654	2.402	1.378	1.232	2.717

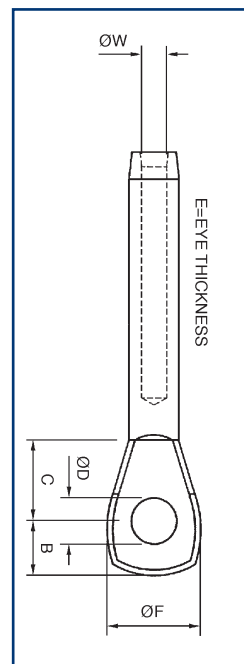

Supplied By;  
**American Rigging Supply, Inc.**  
[www.americanriggingsupply.com](http://www.americanriggingsupply.com)



