

# NORSEMAN SWAGELESS TERMINALS

Norseman Terminals provide a completely secure end fitting on good conventionally constructed strand, Dyform strand and rope for any one using ordinary tools and following the fitting instructions. They have an international reputation for quality, efficiency, versatility and safety.

They feature:

1. Accuracy is achieved first time when rigging, giving economy of labour and materials.
2. Inspection can be undertaken at any time simply by undoing the assembly.
3. In emergency, Norseman Terminals can be fitted at sea in minutes as they do not require power presses, correct temperature conditions or curing time.
4. Terminals can be reused but **MUST** have a new cone.

**Supplied By:**  
**American Rigging Supply, Inc.**  
[www.americanriggingsupply.com](http://www.americanriggingsupply.com)

## SWAGELESS STUD TERMINAL

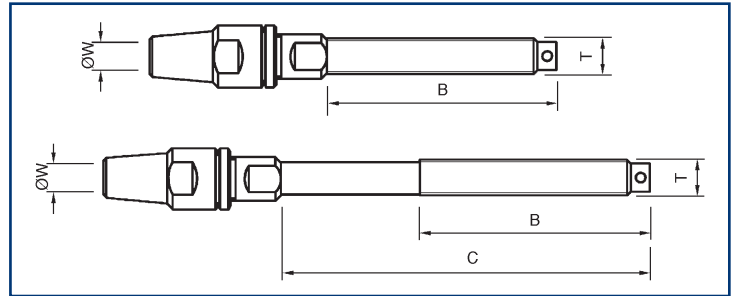

## SWAGELESS LONG STUD TERMINAL



The Norseman Terminal is made from 316 Stainless Steel.

The standard terminal can be used on 1 x 19 strand, 1 x 19 Dyform and 7 strand rope constructions, using the appropriate cone design.

Full technical information is available on request

All fitting supplied with 1 x 19 cones unless otherwise specified.

METRIC PART NO.	WIRE CONSTRUCTION	USA PART NO.
N30	1 x 19	Stud N030 -
N31	7 Strand	Stud N031 -
N32	DYFORM	Stud N032 -

When ordering:-  
 Part No. followed by Size Ref.  
 To order long studs, add 'LONG' after Size Ref.  
 Our standard threads are RIGHT HAND.  
 For LEFT HAND add 'L' to the Part No., i.e., N30-060-1/2L.

## SWAGELESS STUD TERMINAL

SIZE REF	WIRE Ø (mm)	THREAD Ø (UNF)	B (mm)	C (mm)
N30-025-1/4	2.5	1/4	42.0	
N30-030-1/4	3	1/4	42.0	
N30-040-5/16	4	5/16	48.0	
N30-050-5/16	5	5/16	48.0	77.0
N30-050-3/8	5	3/8	65.0	104.0
N30-060-7/16	6	7/16	75.0	120.0
N30-060-3/8	6	3/8	65.0	104.0
N30-060-1/2	6	1/2	83.0	133.0
N30-070-1/2	7	1/2	83.0	133.0
N30-080-1/2	8	1/2	83.0	133.0
N30-080-5/8	8	5/8	98.0	157.0
N30-100-5/8	10	5/8	98.0	157.0
N30-120-3/4	12	3/4	115.0	
N30-120-7/8	12	7/8	138.0	
N30-140-7/8	14	7/8	138.0	
N30-160-1	16	1	155.0	
N30-190-1 1/8	19	1 1/8	180.0	
N30-220-1 1/4	22	1 1/4	200.0	
N30-260-1 3/8	26	1 3/8	219.0	
USA - IMPERIAL DIMENSIONS				
	(ins)	(ins)	(ins)	(ins)
NO30-0308	3/32	1/4	1.654	
NO30-0408	1/8	1/4	1.654	
NO30-0510	5/32	5/16	1.890	
NO30-0610	3/16	5/16	1.890	3.031
NO30-0612	3/16	3/8	2.559	4.094
NO30-0714	7/32	3/8	2.559	4.094
NO30-0812	1/4	3/8	2.559	4.094
NO30-0814	1/4	7/16	2.953	4.724
NO30-0816	1/4	1/2	3.268	5.236
NO30-0916	9/32	1/2	3.268	5.236
NO30-1016	5/16	1/2	3.268	5.236
NO30-1020	5/16	5/8	3.858	6.181
NO30-1220	3/8	5/8	3.858	6.181
NO30-1424	7/16	3/4	4.528	
NO30-1624	1/2	3/4	4.528	
NO30-1628	1/2	7/8	5.433	
NO30-1828	9/16	7/8	5.433	
NO30-2032	5/8	1	6.102	
NO30-2436	3/4	1 1/8	7.087	
NO30-2840	7/8	1 1/4	7.874	
NO30-3244	1	1 3/8	8.622	

Metric Stud Threads available up to 10mm

# SWAGELESS EYE TERMINAL

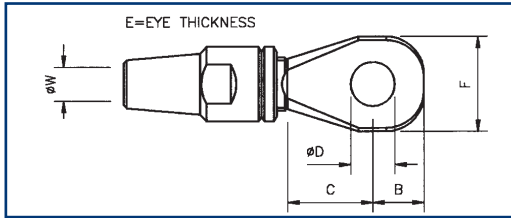

## SWAGELESS EYE TERMINAL

SIZE REF	WIRE $\phi$ (mm)	B (mm)	C (mm)	$\phi D$ (mm)	E (mm)	F (mm)
METRIC DIMENSIONS						
N10-025-1/4	2.5	7.0	11.0	6.5	5.5	13.0
N10-030-1/4	3	7.0	11.0	6.5	5.5	13.0
N10-040-5/16	4	8.2	16.0	8.1	6.7	16.0
N10-050-5/16	5	10.0	16.0	8.1	8.0	16.0
N10-050-3/8	5	10.0	18.0	9.7	8.0	19.0
N10-060-3/8	6	11.0	17.0	9.7	9.0	19.0
N10-060-7/16	6	12.5	19.0	11.3	9.5	23.0
N10-060-1/2	6	13.5	23.5	13.0	9.5	26.0
N10-070-1/2	7	13.5	23.0	13.0	10.8	27.0
N10-080-1/2	8	15.0	24.0	13.0	12.5	27.0
N10-080-5/8	8	18.0	28.0	16.0	12.5	33.0
N10-100-5/8	10	18.0	28.0	16.0	13.5	33.0
N10-120-3/4	12	21.0	39.0	19.2	18.0	40.0
N10-120-7/8	12	25.0	41.0	22.5	18.0	47.5
N10-140-7/8	14	25.0	41.0	22.5	21.0	47.5
N10-160-1	16	27.5	44.0	25.7	24.0	54.0
N10-190-11/8	19	30.0	50.0	29.0	25.7	57.0
N10-220-11/4	22	38.0	55.0	32.0	28.6	63.0
N10-260-13/8	26	42.0	61.0	35.5	31.3	69.0
USA DIMENSIONS						
	(ins)	(ins)	(ins)	(ins)	(ins)	(ins)
NO10-0308	3/32	0.276	0.433	0.256	0.217	0.512
NO10-0408	1/8	0.276	0.433	0.256	0.217	0.512
NO10-0510	5/32	0.323	0.630	0.319	0.264	0.630
NO10-0612	3/16	0.394	0.709	0.382	0.315	0.748
NO10-0716	7/32	0.492	0.748	0.445	0.374	0.906
NO10-0816	1/4	0.531	0.925	0.512	0.374	1.024
NO10-0916	9/32	0.531	0.906	0.512	0.425	1.063
NO10-1016	5/16	0.591	0.945	0.512	0.492	1.063
NO10-1020	5/16	0.709	1.102	0.630	0.492	1.299
NO10-1220	3/8	0.709	1.102	0.630	0.531	1.299
NO10-1424	7/16	0.827	1.535	0.756	0.709	1.575
NO10-1624	1/2	0.827	1.535	0.756	0.709	1.575
NO10-1828	9/16	0.984	1.614	0.886	0.827	1.870
NO10-2032	1.870	1.732	1.012	0.945	2.126	6.890
NO10-2436	3/4	1.181	1.969	1.142	1.012	2.244
NO10-2840	7/8	1.496	2.165	1.260	1.126	2.480
NO10-3244	1	1.654	2.402	1.398	1.232	2.717

# SWAGELESS FORK TERMINAL

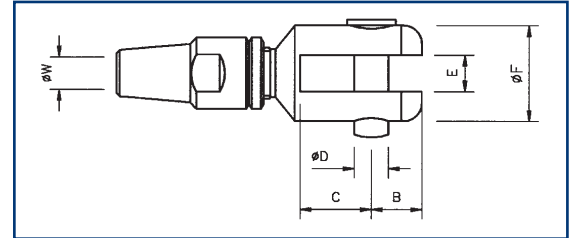

## SWAGELESS FORK TERMINAL

SIZE REF	WIRE $\phi$ (mm)	A (mm)	B (mm)	C (mm)	$\phi D$ (mm)	E (mm)
METRIC DIMENSIONS						
N20-025-1/4	2.5	8.0	13.0	6.3	6.3	14.0
N20-030-1/4	3	8.0	13.0	6.3	6.3	14.0
N20-040-5/16	4	10.0	16.0	7.9	7.9	19.0
N20-050-5/16	5	10.0	16.0	7.9	7.9	19.0
N20-050-3/8	5	12.0	19.0	9.5	9.5	22.0
N20-060-3/8	6	12.0	19.0	9.5	9.5	22.0
N20-060-7/16	6	14.0	22.0	11.1	11.1	28.5
N20-060-1/2	6	16.0	25.5	12.7	12.7	31.5
N20-070-1/2	7	16.0	25.5	12.7	12.7	31.5
N20-080-1/2	8	16.0	25.5	12.7	12.7	31.5
N20-080-5/8	8	20.0	32.0	15.8	15.8	38.0
N20-100-5/8	10	20.0	32.0	15.8	15.8	38.0
N20-120-3/4	12	24.0	38.0	19.0	19.0	47.5
N20-120-7/8	12	28.0	44.5	22.2	22.2	54.0
N20-140-7/8	14	28.0	44.5	22.2	22.2	54.0
N20-160-1	16	32.0	51.0	25.4	25.4	63.5
N20-190-11/8	19	36.0	57.0	28.5	28.5	70.0
N20-220-11/4	22	40.0	63.5	31.7	31.7	76.0
N20-260-13/8	26	44.0	70.0	35.0	35.0	82.5
USA - IMPERIAL DIMENSIONS						
	(ins)	(ins)	(ins)	(ins)	(ins)	(ins)
NO20-0308	3/32	0.315	0.512	0.248	0.248	0.551
NO20-0408	1/8	0.315	0.512	0.248	0.248	0.551
NO20-0510	5/32	0.394	0.630	0.311	0.311	0.748
NO20-0610	3/16	0.394	0.630	0.311	0.311	0.748
NO20-0712	7/32	0.472	0.748	0.374	0.374	0.866
NO20-0812	1/4	0.472	0.748	0.374	0.374	0.866
NO20-0816	1/4	0.551	0.866	0.437	0.437	1.122
NO20-0916	9/32	0.630	1.004	0.500	0.500	1.240
NO20-1016	5/16	0.630	1.004	0.500	0.500	1.240
NO20-1020	5/16	0.787	1.260	0.622	0.622	1.496
NO20-1220	3/8	0.787	1.260	0.622	0.622	1.496
NO20-1424	7/16	0.945	1.496	0.748	0.748	1.870
NO20-1624	1/2	0.945	1.496	0.748	0.748	1.870
NO20-1828	9/16	1.102	1.752	0.874	0.874	2.126
NO20-2032	5/8	1.260	2.008	1.000	1.000	2.500
NO20-2436	3/4	1.417	2.244	1.122	1.122	2.756
NO20-2840	7/8	1.575	2.500	1.248	1.248	2.992
NO20-3244	1	1.732	2.756	1.378	1.378	3.248

METRIC PART NO.	WIRE CONSTRUCTION	USA PART NO.
N10	1 x 19	Eye N010 -
N11	7 Strand	Eye N011 -
N12	DYFORM	Eye N012 -

When ordering - Part No. followed by Size Ref.

METRIC PART NO.	WIRE CONSTRUCTION	USA PART NO.
N20	1 x 19	Fork N020 -
N21	7 Strand	Fork N021 -
N22	DYFORM	Fork N022 -

# SWAGELESS FITTING METHOD

May be hand fitted without the use of special tools. Simply slip the body of the terminal over the full diameter of the cable. Unlay the outer wires and fit the cone over the centre core. Re-lay the outer wires. Ease the ends of the wires into the head of the fitting. Draw the body up to the head and screw together.

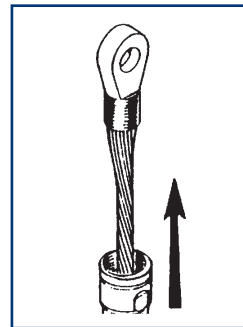
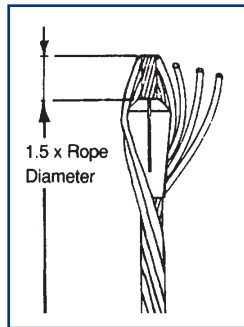
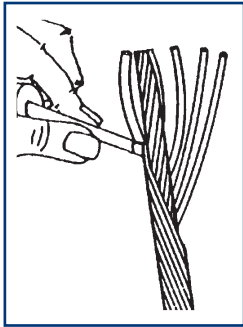

Note \* One of the unfortunate characteristics of stainless steel threaded components is a slight risk of thread galling or seizing. On certain sizes of Norseman terminals the male thread has been coated with a special anti-friction compound, to eliminate the risk of thread galling or seizing. Care has been taken only to apply this coat to approximately half the threaded length, in order that there is sufficient uncoated steel for the recommended thread locking compound to take hold.

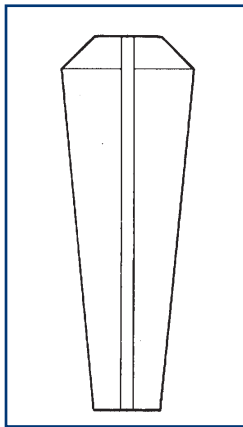

1 x 19

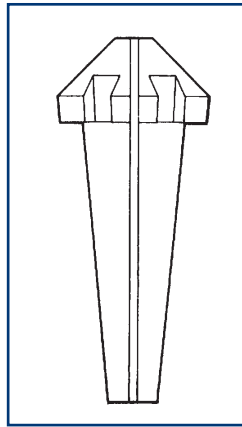

7 STRAND

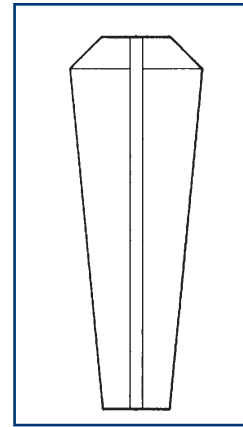

DYFORM

S - Self Colour  
Y - Yellow  
B - Blue  
G - Green  
R - Red  
W - White

CONES						
PART NO.	SIZE		COLOUR			USA PART NO.
	(mm)	(in)	1 x 19	7 Strand	Dyform	
CC-025	2.5	3/32	B	Y	-	NCC-03
CC-030	3		S	R	-	
CC-032		1/8	G	Y	-	NCC-04
CC-040	4	5/32	S	R	-	NCC-05
CC-050	5	3/16	S	R	W	NCC-06
CC-055		7/32	B	Y	-	NCC-07
CC-060	6		S	R	W	
CC-063		1/4	G	Y	W	NCC-08
CC-070	7	9/32	S	R	W	NCC-09
CC-080	8	5/16	S	S	W	NCC-10
CC-090	9		B	Y	-	
CC-095		3/8	G	Y	W	NCC-12
CC-100	10		S	S	W	
CC-110	11	7/16	B	Y	W	NCC-14
CC-120	12		S	S	W	
CC-127		1/2	G	R	W	NCC-16
CC-140	14	9/16	S	S	W	NCC-18
CC-160	16	5/8	S	S	W	NCC-20
CC-190	19	3/4	S	S	W	NCC-24
CC-220	22	7/8	S	S	-	NCC-28
CC-260	26	1	S	S	-	NCC-32
CC-280	28		S	-	-	
CC-300	30		S	-	-	
CC-320	32		S	-	-	
	CC - 1 x 19		CS - 7 Strand		CD - Dyform	

# MAST TERMINAL SYSTEMS

## SHROUD TERMINAL 841

This shroud termination system has resulted from a long test program to determine the optimum design for a quick release terminal. It retains all the advantages of the conventional T terminal, while offering higher strength and markedly improved service life under heavy load conditions, ideal for use with Dyform rigging wire.

The redesigned backing plate provides improved articulation with the head of the terminal and also allows the reduction of the angle of the head which is the key to higher strength.

Only a circular hole is required in the mast.

The Gibb secondary bend is retained to ensure correct alignment of cable and terminal.

It is available for metric and imperial cable from 6mm (7/32") diameter and suitable for all forms of swaging equipment, or with the Norseman terminal version for fitting by hand. The use of the retaining plug is recommended to ensure accidental disengagement is not possible when shrouds are released, or in applications such as running backstays and babystays.

WIRE PLUG Ø	SWAGE PART NO.	SWAGELESS PART NO.	BACKING PLATE PART NO.	RETAINING PART NO.
METRIC DIMENSIONS				
6	841-6	N80-060	840-6	842-6
7	841-7	N80-070	840-7	842-8
8	841-8	N80-080	840-8	842-8
10	841-10	N80-100	840-10	842-10
12	841-12	N80-120	840-12	842-12
USA - IMPERIAL DIMENSIONS				
7/32	N841-07	N080-07	N840-07	N842-07
1/4	N841-08	N080-08	N840-07	N842-07
9/32	N841-09	N080-09	N840-09	N842-09
5/16	N841-10	N080-10	N840-10	N842-09
3/8	N841-12	N080-12	N840-12	N842-12
7/16	N841-14	N080-14	N840-14	N842-14
1/2	N841-16	N080-16	N840-14	N842-14



## 'T' BALL TERMINAL 741

The traditional T ball terminal, manufactured from quality 316 Stainless Steel with either swage or swageless fitting.



WIRE Ø	SWAGE PART NO.	SWAGELESS PART NO.	BACKING PLATE PART NO.	RETAINING PLUG PART NO.
METRIC DIMENSIONS				
2	741-2	-	740-3	742-3
2.5	741-2.5	N70-025	740-3	742-3
3	741-3	N70-030	740-3	742-3
4	741-4	N70-040	740-4	742-4
5	741-5	N70-050	740-5A	742-5A
6	741-6	N70-060	740-7	742-7
7	741-7	N70-070	740-7	742-7
8	741-8	N70-080	740-10	742-10
10	741-10	N70-100	740-10	742-10
USA - IMPERIAL DIMENSIONS				
3/32	N741-03	N070-03	N740-03	N742-03
1/8	N741-04	N070-04	N740-03	N742-03
5/32	N741-05	N070-05	N740-05	N742-05
3/16	N741-06	N070-06	N740-06	N742-06
7/32	N741-07	N070-07	N740-07	N742-07
1/4	N741-08	N070-08	N740-07	N742-07
9/32	N741-09	N070-09	N740-07	N742-07
5/16	N741-10	N070-10	N740-10	N742-10
3/8	N741-12	N070-12	N740-10	N742-10

# T RINGS 743

T Rings are designed to allow advanced high performance fiber ropes to be connected to spars through a conventional T Terminal backing plate. Using T Rings and rope considerable weight can be saved for quick connection applications such as runners and backstays on yachts and trapezes on dinghies.

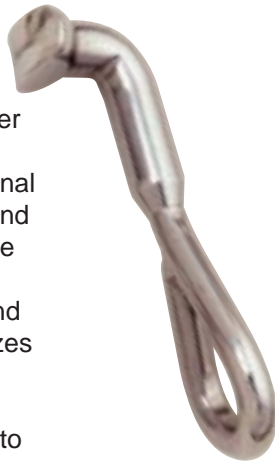

METRIC PART NO.	1 x 19 EQUIVALENT	BREAK LOAD	FITS BACKING PLATE #	USA PART #
743-3	3mm	720 kg	N740-03	N743-03
743-4	4mm	1280 kg	N740-05	N743-05
743-5	5mm	2000 kg	N740-06	N743-06
743-6	6mm	2880 kg	N740-07	N743-07

This product can be retro fitted to masts already fitted with T Terminal mast slots. There are 4 sizes covering every requirement from dinghy to 50' yacht.

**NEW PRODUCT**

# SWAGELESS STEMBALL TERMINAL N60

# STEMBALL TERMINAL 641

For mast attachment, please see the Navtec K200 Tang detailed on page 34.



WIRE Ø	SWAGE PART NO.	SWAGELESS PART NO.	CUP PART NO.
METRIC DIMENSIONS			
3	641-3	N60-030	640-4
4	641-4	N60-040	640-4
5	641-5	N60-050	640-5
6	641-6	N60-060	640-7
7	641-7	N60-070	640-7
8	641-8	N60-080	640-12
10	641-10	N60-100	640-12
USA - IMPERIAL DIMENSIONS			
1/8	N641-04	N060-04	N640-04
5/32	N641-05	N060-05	N640-04
3/16	N641-06	N060-06	N640-06
7/32	N641-07	N060-07	N640-07
1/4	N641-08	N060-08	N640-08
9/32	N641-09	N060-09	N640-08
5/16	N641-10	N060-10	N640-10
3/8	N641-12	N060-12	N640-10



# STEMBALL CUP 640

# STEMBALL EYE 639

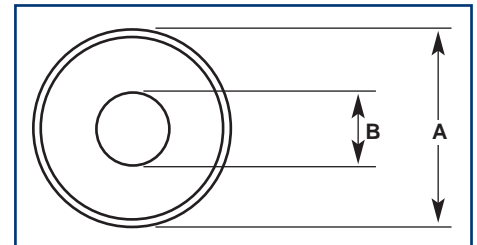

METRIC PART NO.	CUP Ø (mm)	PIN Ø (in)	USA PART NO.
639 - 26 - 3/8	26	3/8	N639-3212
639 - 26 - 7/16	26	7/16	N639-3214
639 - 26 - 1/2	26	1/2	N639-3216
639 - 34 - 1/2	34	1/2	N639-4416
639 - 34 - 5/8	34	5/8	N639-4420

METRIC PART NO.	A Ø (mm)	B Ø (mm)	USA PART NO.
640-4	26	9.00	N640-04
640-5	26	11.00	N640-06
640-6	26	13.25	N640-07
640-7	26	16.30	N640-08
640-12	34	20.00	N640-10