

## Swageless Compression Terminals

The latest development for compression fittings results in a termination at least as strong as the rated breaking load of the wire rope. The unique star shaped Crown Ring positions and holds the wire strands in place, eliminating the requirement for awkward wire end bending. The shallow angled cone establishes direct mechanical grip on the core and all outer strands. Stainless steel grade EN10088 1.4404 (316) is used on all parts with the exception of the crown ring which is manufactured from Aluminium Bronze. No sealant or packing is required.

### Compression Eyes

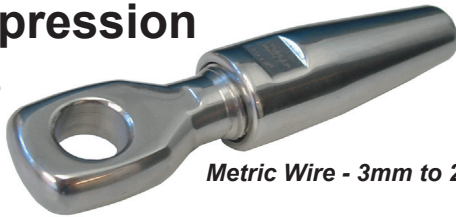

Metric Wire - 3mm to 26mm

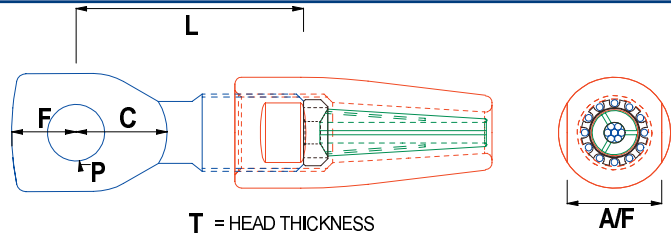

PRODUCT CODE	W	P	F	C	L	T	A/F	WEIGHT
CTE03	3mm	6.3mm	7mm	9mm	22mm	6mm	9.5mm	21g
CTE04	4mm	8mm	9mm	12mm	28mm	7mm	11mm	39g
CTE05	5mm	9.5mm	11mm	16mm	32mm	8mm	14mm	65g
CTE06	6mm	11mm	13mm	19mm	38mm	9.5mm	17mm	126g
CTE06US	6mm	12.7mm	13mm	20mm	43mm	11mm	17mm	140g
CTE07	7mm	12.7mm	13mm	20mm	45mm	11mm	20mm	165g
CTE08DS	8mm	12.7mm	13mm	20mm	48mm	11mm	22mm	235g
CTE08	8mm	14.3mm	16mm	23mm	52mm	13mm	22mm	355g
CTE08US	8mm	16mm	19mm	28mm	56mm	15mm	22mm	390g
CTE10	10mm	16mm	19mm	28mm	59mm	15mm	26mm	462g
CTE10US	10mm	19mm	22mm	34mm	65mm	18mm	26mm	600g
CTE11	11mm	19mm	22mm	34mm	65mm	18mm	26mm	600g
CTE12	12mm	19mm	22mm	34mm	79mm	18mm	32mm	912g
CTE14	14mm	22.2mm	26mm	36mm	86mm	22mm	36mm	1344g
CTE16	16mm	25.4mm	29mm	41mm	94mm	24mm	40mm	1867g
CTE19	19mm	28mm	32mm	44mm	98mm	28mm	44mm	2227g
CTE22	22mm	32mm	36mm	50mm	108mm	32mm	52mm	3440g
CTE26	26mm	35mm	42mm	55mm	144mm	34mm	64mm	5575g

### Description of Compression Terminals

Several innovative features result in a better swageless product. The star shaped Crown Ring (fig.1) holds the wire strands in place during and after assembly, and prevents the need for awkward "wire end bending". The Crown Ring is separated from the wire cone and therefore is not slotted, this prevents the outer strands from being trapped in the cone slots. The Crown Ring also accommodates left and right hand lay wire ropes. The shallow cone angle establishes more mechanical advantage providing a tighter grip. The terminal can be completely dismantled for maintenance then re-used. All component parts are re-useable providing that no overloading has occurred. The diagrams below (fig.2 & 3) demonstrate the different crown rings required for different wire sizes.



Fig. 1 - Crown Ring



Fig. 2 - Wire size < 5mm

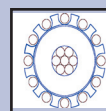

Fig.3 - Wire Size >= 5mm

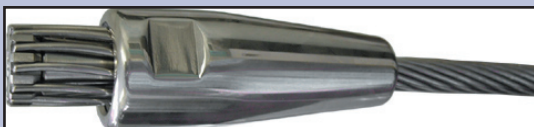

Fig. 4 - Shallow angled cone at 8 degrees allows for more mechanical grip.

All parts are manufactured from stainless steel grade EN10088 1.4404 (316) with the exception of the Crown Ring, which is made from Aluminium Bronze. Use of these materials means that there is no need for sealant or packing

The part codes in the tables are for 1X19 wire rope construction. Different Cones and Crown Rings are used for 7 strand and compact strand. Add suffix -7 or -C for these assemblies.