

Edson Pull-Pull Conduit Systems are designed to provide the ability to run steering cables around spaces or structures that otherwise might be difficult or impossible with straight wire runs from sheave to sheave. Pull-Pull System components have been engineered to allow you to use stock parts that will result in a strong, reliable and sensitive steering system. However, you must carefully follow the guidelines at the right to insure a system that is free of friction. *Boats over 60' (18 m) should use the larger size 312 Conduit and Fittings.*

Pull-Pull Steering System Design Guidelines:

- Conduit should have no 90° bends—however gentle—on boats over 30', as it will make the steering stiff.
- Use Edson Conduit Idlers whenever possible when conduit needs to make a turn.
- Conduit should be utilized only to make slight elevation changes and gentle bends.
- Conduit Greasers should be used on all runs over 6' (2 m).
- Lubricate monthly with Teflon™ based lubricant only.

Pull-Pull Conduit and Fittings

Edson's Pull-Pull Conduit is available in one foot increments. The conduit can easily be cut with a hacksaw. Specify length in feet when ordering.

3/4" (19mm) OD Conduit for 3/16" & 1/4" wire rope – Order #853-250

Wt. 5.5 oz/ft

7/8" (22mm) OD Conduit for 5/16" wire rope – Order #853-312

Wt. 9 oz/ft

Edson's Conduit End Fittings. Two fittings are required for each length of conduit. #854-250 fittings are molded in white Celcon™ #854-312 fittings are black anodized, machined Aluminum. Both have end fitting thread size of 7/8"-9. Comes with 1 Hose Clamp.

Conduit End Fittings for #853-250 Conduit – Order #854-250

Wt. 2 oz

Conduit End Fittings for #853-312 Conduit – Order #854-312

Wt. 4 oz

Edson's Pull-Pull Conduit Assemblies include specified length of Conduit and two End Fittings. They are cut to length and assembled at the Edson Factory. Two lengths are needed in most steering system installations. The length should be measured from end-to-end including 2 1/2" (64mm) for each end fitting.

Conduit Assembly w/ #853-250 Conduit – Order #797

Specify length – See Price Sheet.

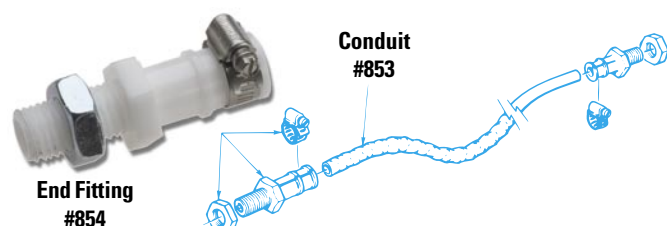

Pull-Pull Conduit Idlers

Edson's Flat Conduit Idler is similar to the #881 Upright Idler, but is designed to mount on a flat surface. Constructed of anodized aluminum sheaves and a brass housing.

4" Flat Conduit Idler – Order #847BR-4AL

Wt. 2 lb (.9kg)

6" Flat Conduit Idler – Order #847BR-6AL

Wt. 4 lb (1.8kg)

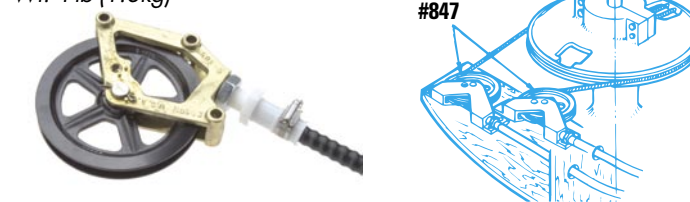

Edson's In-Out Conduit Idler is designed to increase the efficiency and sensitivity of a Pull-Pull Conduit System. Engineered with 6" sheaves and three holes to accept Edson's Conduit End Fittings, the idler makes wire alignment with the sheave automatic. It is recommended that these idlers be used at major load points in engine compartments to allow the steering cable to run over a sheave when being routed aft. Required on center cockpit pull-pull systems over 39' (12 m).

6" In-Out Conduit Idler – Order #962-6AL

Wt. 3.5 lb/1.6 kg

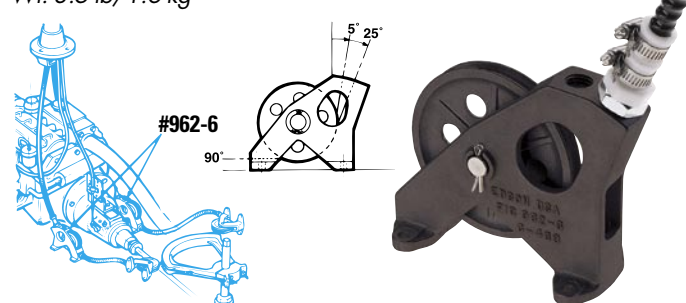

Edson's Upright Conduit Idlers allow you to turn steering cable around a sheave rather than through the conduit, reducing wear and friction. Upright Conduit Idlers are an absolute must on boats over 39' (12m). Available in cast and machined Aluminum or Bronze in five sizes.

Upright Conduit Idlers – Order #881

(See Ordering Guide, Specify AL or BR)



UPRIGHT CONDUIT IDLER ORDERING GUIDE

Order #	Sheave Dia. in (cm)	Max Wire Size in (mm)	Total Weight lbs. (kg)	
			Aluminum	Bronze
881BR-4AL	4" (10.2)	3/8" (7 mm)	n/a	2 lbs (.9 kg)
881BR-6AL	6" (15.2)	3/4" (10 mm)	n/a	4 lbs (1.8 kg)
881(*)-8(*)NB	8" (20.3)	1/2" (13 mm)	7 lbs (3.2 kg)	13 lbs (5.9 kg)
881(*)-10(*)NB	10" (25.4)	1/2" (13 mm)	11 lbs (5.0 kg)	21 lbs (9.5 kg)
881(*)-12(*)NB	12" (30.5)	3/4" (19 mm)	17 lbs (7.7 kg)	36 lbs (16.3 kg)

* Specify AL for aluminum or BR for Bronze.

6" Sheave available with bronze oilite or stainless needle bearing - see price page.

Pull-Pull Conduit Brackets

Edson's Drop Conduit Bracket drops the conduit ends 2" (51mm) below the cockpit floor (more if blocked down). This makes it easier to feed wires into the conduit and allows for easier lubrication and maintenance of the conduit system. It is held in place by the pedestal mounting bolts. Aluminum construction.

Drop Conduit Bracket - Order #841-2

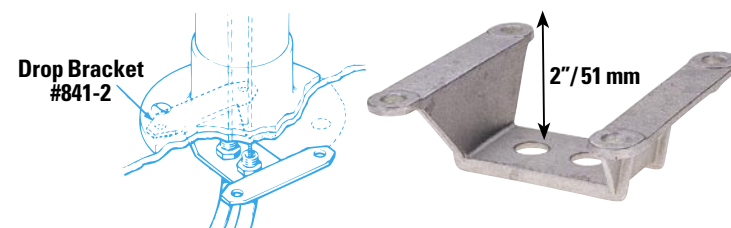

Edson's Internal Conduit Bracket mounts inside the pedestal column, allowing the conduit to hug the bottom of the cockpit floor. For ease of installation and maintenance, it is held in position by the pedestal mounting bolts.

Internal Conduit Bracket - Order #868-2

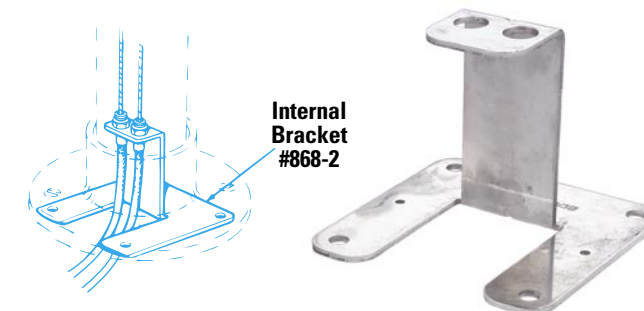

Edson's Pull-Pull Conduit Bracket with Rudderstop is ideal for terminating the conduits at the quadrant when there are no bulkheads to utilize. It is easily bolted through the cockpit sole and comes with its own rudderstop post.

12" / 30 cm Conduit Bracket with Rudderstop – Order #824-12

Wt. 2.75 lb (1.2 kg)

17" / 43 cm Conduit Bracket with Rudderstop – Order #824-17

Wt. 3.3lb (1.5 kg)



CONDUIT BRACKET DIMENSION GUIDE

Order #	A	B	C	D
824-12	3" (7.6mm)	12" (30.5mm)	1 1/4" (4.5mm)	2 3/8" (6.7mm)
824-17	3" (7.6mm)	17" (43.2mm)	1 1/4" (4.5mm)	2 3/8" (6.7mm)

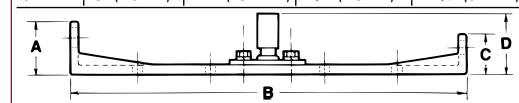

Edson's Right Angle Bracket, mounted below a bulkhead steerer, provides an easy anchoring point for both conduit end fittings.

Right Angle Conduit Bracket - Order #799-2

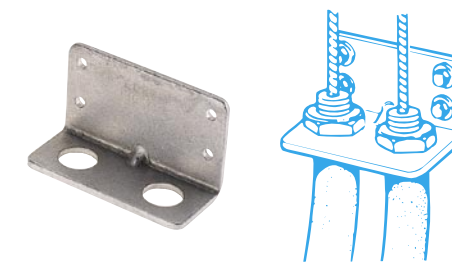

Edson's Reversible Sheave Bracket Rudderstop is for use on boats where both conduits run together from a midship cockpit aft to the rudderpost. One conduit attaches to the aluminum bracket, the second conduit attaches to the sheave housing, both cables line up with the grooves in the quadrant. The bracket is cast of heat treated aluminum with an anodized aluminum sheave. It can be used in either a port or starboard mode by moving the sheave to the pre-tapped mounting holes on the opposite side of the bracket.

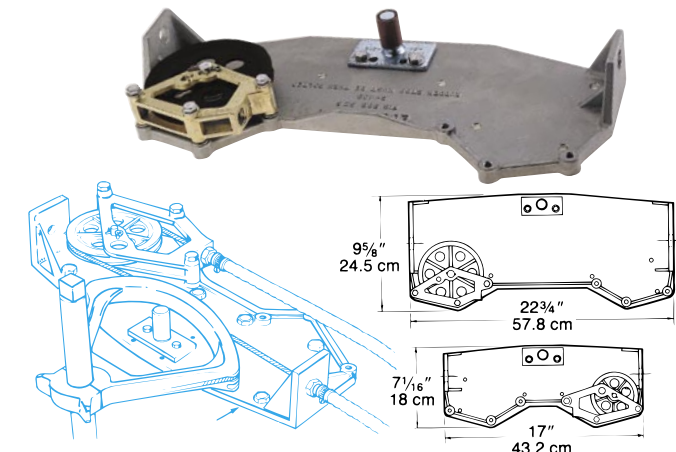

REVERSIBLE SHEAVE BRACKET ORDERING GUIDE

Order #	Length in (cm)	Width in (cm)	Sheave Size in (cm)	Wire Rope in (mm)	Max Quadrant Size in (cm)	Weight lbs (kg)
908-4	17 (43.2)	7 (17.8)	4 (10.2)	3/16 (4.8)	14 (35.6)	7.2 (3.3)
908-6	23 (58.4)	9.25 (23.5)	6 (15.2)	1/4 (6.35)	20 (50.8)	11.2 (5.1)

Pull-Pull Accessories



14 oz Lubricant #827-14

3 oz Lubricant #827-3

Edson's Conduit Lubricant is a Teflon® grease for use in all Edson Systems. Ideal for both conduit and needle bearing use.
14 oz. Cartridge – Order #827-14
3 oz. Tube – Order #827-3
1/2 oz. tube (not shown) - Order #827-.50

Edson's In-Line Conduit Greasers are a simple, efficient way to lubricate your conduit. One should be installed in an accessible area of straight conduit as close to the middle of each run as possible - preferably every 3'-5' where serviceable. Comes complete with two clamps and grease cup. Two sizes match Edson Conduit; #918-250 is molded white Celcon™, #918-312 is black anodized aluminum.

In-Line Greaser for #853-250 Conduit – Order #918-250C

Wt. 4oz (112g)

In-Line Greaser for #853-312 Conduit – Order #918-312

Wt. 7.5oz (121g)



Bronze Fairlead #904

Edson's Bronze Conduit Fairleads placed at regular intervals, secure the conduit and make a neat, clean installation.

Fairlead for #853-250 Conduit – Order #904-250

Fairlead for #853-312 Conduit – Order #904-312