



Edson's Pedestal Guards are designed to protect your compass and to provide a firm handhold for your crew. The Guard is narrow enough for crew members to slide by and it affords extra protection on those boats with a mainsheet traveler just forward of the pedestal.

- Marine-Grade Stainless Construction
- Provides the ability to mount convenience items such as Cockpit Tables, Drink Holders, Chart Board, Instrument Housings, etc.
- All Edson Guard Kits come complete with Stainless Guard Tube, Stainless Top Plate and Stainless Guard Feet.
- Three versions to accommodate various instrument and housing combinations.
- Extra Large 1 1/8" Diameter Tubing on 9 1/2" (24.1 cm) wide centers gives more space for instrument wiring.

## 58" Straight Guard

Provides protection for your compass, a convenient handhold and the ability to mount Instrument Housings, Radar Pods or multiple displays while increasing their visibility.

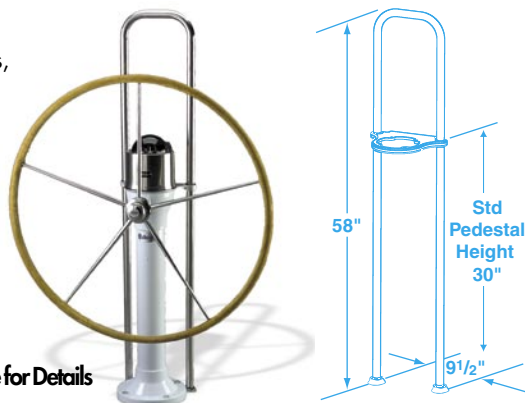

Order #1600  
See Ordering Guide for Details

## 58" Angled Guard

Gives you extra room to install Instrument Housings, Radar Pods or multiple displays while the new angle increases their visibility.

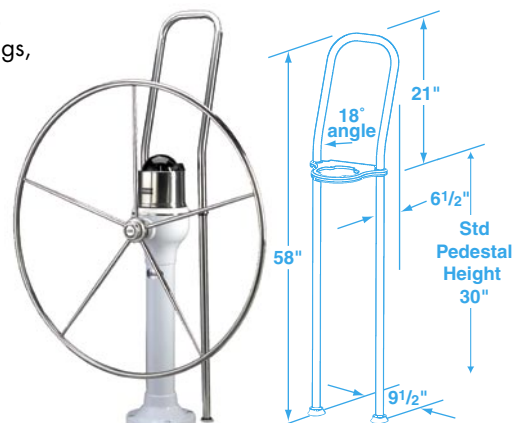

Order #1620  
See Ordering Guide for Details

## 58" Offset Guard

Edson's most versatile Guard, the Offset Guard provides you with better instrument visibility because we have moved the instruments forward by 7" (124.5 cm).

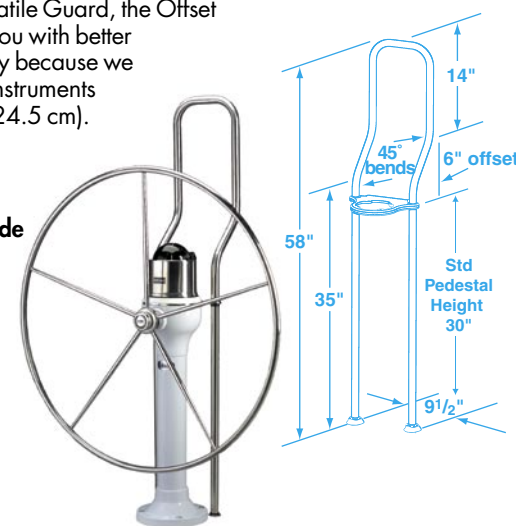

Order #1610  
See Ordering Guide for Details

### Replacement Stainless Top Plates and Guard Feet



Stainless Top Plate

Included with all Pedestal Guard Kits, Edson's **Stainless Top Plate** is made of Investment-cast 316 Stainless and polished to a mirror finish. It will accommodate 1", 1-1/8" and 1-1/4" pedestal guard tubing on 9-1/2" centers with the provided plastic bushings. These also provide rattle-free isolation between the stainless tubes and top plate, making removal in the future easier. It can be ordered separately, so you can upgrade your older pedestal with the white aluminum version.

**Stainless Top Plate Only**  
For 335 & 336 Pedestals - Order #1625ST-45  
For #400, 402 & 464 Pedestals - Order #1625ST-6



Stainless Guard Feet

Can also be ordered in pairs as a direct replacement for Edson's black plastic feet. Gasket and bushing allow for mounting 1", 1-1/8" or 1-1/4" guard pipes. Nuts and washers included.

**Stainless Guard Feet Kit - Order #310ST-100-125**

### PEDESTAL GUARD KIT ORDERING GUIDE

Edson Pedestal Guard kits come complete with Stainless Guard Pipe, Top Plate and Feet. All are 9 1/2" wide on center. The Guard Top Plate fits directly on top of the Pedestal or Engine Control. The diameter of the Pedestal Bowl defines the proper kit size to order.

To Fit Pedestal	Pedestal Bowl Top Dia.	Order #			Stainless Top Plate Only
		58" Straight Guard Kit (Each includes Stainless Top Plate and Feet)	58" Offset Guard	58" Angled Guard	
335, 336, 337	6 7/8" (17.2 cm)	1600-45-58S	1610-45-58OS	1620-45-58A	1625ST-45
400, 402, 464 CDi Classic	8" (20.3 cm)	1600-6-58S	1610-6-58OS	1620-6-58A	1625ST-6
1 1/4" Guard Pipe Only	N/A	960-B-781	960-B-782	960-B-784	N/A
SS Guard Feet Only	N/A	#310ST-100-125 (for all sizes)			N/A

## Pedestal Wheel Brake for Pre-2003 Steerers

The **Edson Friction Brake for Pedestal Steerers** is designed to dampen the action of the wheel and is the most popular accessory for all steerers. Especially handy on long runs or when operating under power, these brakes can be used to secure the wheel under most conditions and will hold the boat on course while the helmsman trims a sheet or goes below. The brake can always be overridden by the helmsman. Brakes are constructed of bronze with long-lasting brake linings and are supplied with a stainless shaft and brake knob. For safety, the handle is designed to "pop off" if a line gets tangled around it. Edson pre-drills all holes required for the installation of the wheel brake which allows an Edson wheel brake to be retrofitted in approximately 20 minutes.

**NOTE:** Since 2003, all steerers feature thru-shaft wheel brakes and this brake kit is not applicable for these newer pedestals.

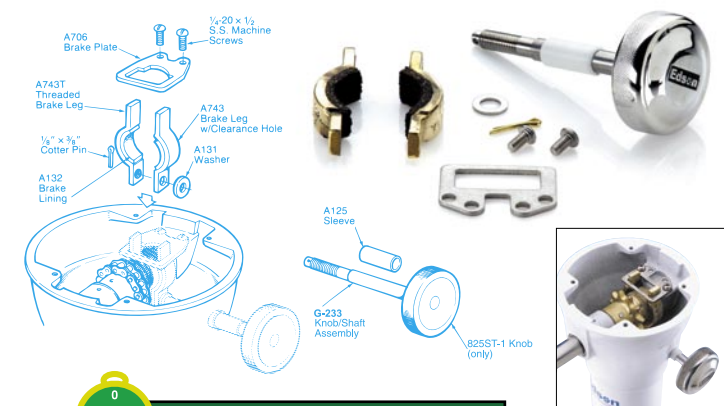

**Installation Time**

0, 15, 30, 45 minutes

**Brake can be installed in approximately 20 minutes!**

### WHEEL BRAKE ORDERING GUIDE

DESCRIPTION	ORDER #
Wheel Brake for older Edson Pedestals #334, 335 and 400.	#689ST-456
Wheel Brake w/8" Shaft for #410 Steerers	#689ST-8
Wheel Brake w/12" Shaft for #410 Steerers	#689ST-12
Stainless Replacement Knob	#825ST-1
Edson Brake Maintenance Kit	#316-689

**Edson's Stainless Replacement Brake Knob** can be easily retrofitted onto your older Edson Pedestal. Easy press-on installation requires no tools.  
**Order #825ST-1**

**Edson's Brake Maintenance Kit** includes everything you need, including brake pads and adhesive, to bring new life into your older Edson brake.  
**Order #316-689** (See Page 8).

## Optional Pedestal Bases

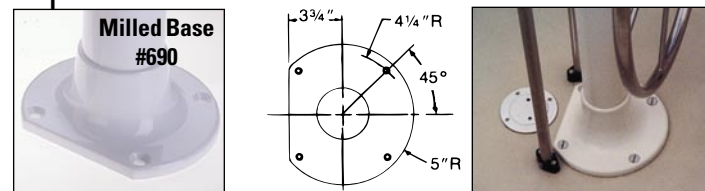

**Edson's Milled Base** is ideal for steerers up against a bridge deck or emergency tiller fittings. The Milled Base is adaptable to all Edson Pedestals. Removes 1 1/4" from either the aft or forward side of the pedestal. **NOTE:** As all pedestals are pressed and welded together, base must be ordered with pedestal. Edson's #646 Hex Head Bolts must also be used. Allow 2-3 weeks extra delivery time.

**Milled Base Forward - Order #690-4MBF**  
**Milled Base Aft - Order #690-4MBA**

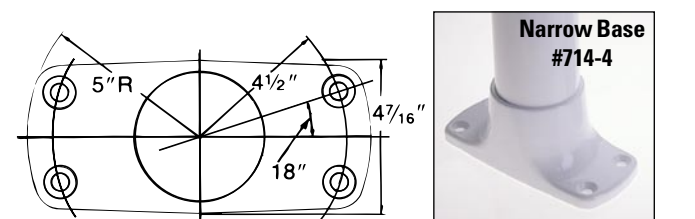

**Edson's Narrow Base** - For a narrow bridge deck or for pedestals up to about 15" (380mm) high. Adaptable to all Edson pedestals. **NOTE:** As all pedestals are pressed and welded together, base must be ordered with pedestal. Edson's #646 Flat Head Bolts must also be used. Allow 2-3 weeks extra delivery time.

**Narrow Base - Order #714-4**

## Aluminum Pedestal Bolts



**Edson's Aluminum Pedestal Bolts** - Four Required. Since 1987, all Edson Pedestals use the exclusive Edson Hex Head Aluminum Bolts. With this improvement they lock in place and require only one person to tighten them. They fit flush with the base and the aluminum alloy is the same as the base thus eliminating all reaction from dissimilar metals. Flat head bolts are still available for boats with pedestals installed prior to February 1987.

- 4" Hex Head Aluminum Bolts - Order #646-4HEX
- 6" Hex Head Aluminum Bolts - Order #646-6HEX
- 8" Hex Head Aluminum Bolts - Order #646-8HEX
- 4" Flat Head Aluminum Bolts - Order #646-4FLAT

## Pedestal Risers



**Edson's Pedestal Risers** - Cast in Aluminum and finished in a highly durable glossy white baked-on urethane. These risers will raise your pedestal for more steering wheel clearance. Size 10 raises the pedestal 1" / 25 mm, Size 25 raises the pedestal 2 1/2" (64mm). You may need to order longer #646 Pedestal Bolts.  
**1" (25mm) Pedestal Riser - Order #945-10**  
**2 1/2" (64mm) Pedestal Riser - Order #813-25**

**GO TO**

**See Tech Tip on pg. 38 for Pedestal Sizing Information**

Pedestal Accessories

Pedestal Accessories