



Edson's Standard Clutch and Throttle Control features matching stainless control handles which are conveniently located on each side of the pedestal and are clearly marked for "Forward" and "Reverse", "Fast" and "Slow". For precision speed control there is a Throttle Friction Adjustment Screw inside the housing. This control is easy to install and can be used with any transmission that uses 33 Series (Edson #734) cables such as: Hurth and Borg Warner Velvet Drive Transmissions typically found on Universal, Ford Lehman, Yanmar and Westerbeke engines. This control should only be used where pulling on the clutch cable end engages the transmission in forward gear. If the opposite occurs, the #816 shown below should be used.

Clutch & Throttle Control for 334, 335, 336 & 337 Pedestals - Order #870ST-45
Clutch & Throttle Control for 400, 402 & 403 Pedestals - Order #870ST-6



#870ST Engine Control includes Clutch and Throttle Control Housing, Stainless Handles, Clevises, Cable Holder, and all necessary hardware.

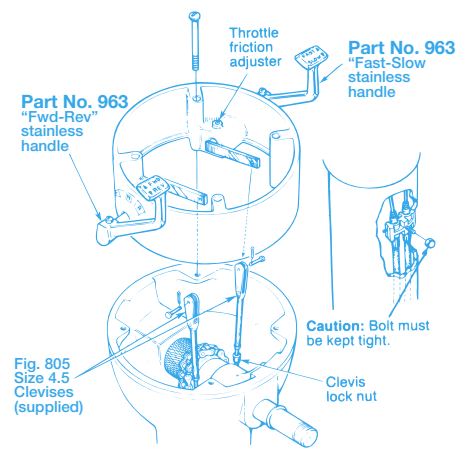

Edson Clutch and Throttle Control is designed for transmissions that go into reverse when the cable is extended at the pedestal end. Also for harder to shift transmissions. Only for transmissions that specify 33 Series (Edson #734) Control Cables. The clutch handle is 6" (152mm) long and is easily operated up and down by reaching over the wheel. The Throttle Handle is polished Stainless and clearly marked for "Fast" and "Slow" speeds. A Throttle Friction Adjustment Screw and a Clutch Travel Limiter are standard features.

Clutch & Throttle Control for No. 334, 335, 336 & 337 Pedestals - Order #816ST-45

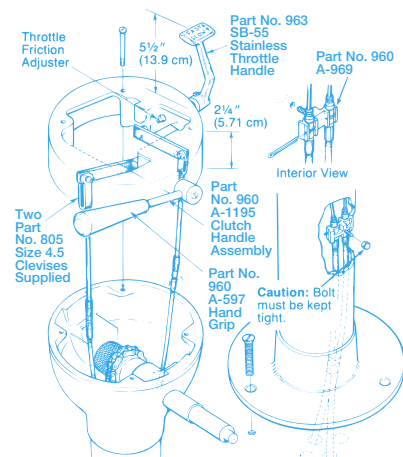

Edson "Mechanical Shift" Clutch and Throttle Control is designed for use with 64 Series (Edson #735) Transmission Cables and 33 Series (Edson #734) Throttle Cables. The clutch handle is 10" (254mm) long to provide increased shifting leverage for Atomic 4 and other hard to shift transmissions. The Part No. 963SB-55 Throttle Handle is polished Stainless and clearly marked for "Fast" and "Slow" speeds. A Throttle Adjustment Screw is a standard feature.

Clutch & Throttle Control for No. 334, 335, 336 & 337 Pedestals - Order #751ST-45



#751ST Engine Control includes all of the parts shown in the above photo.

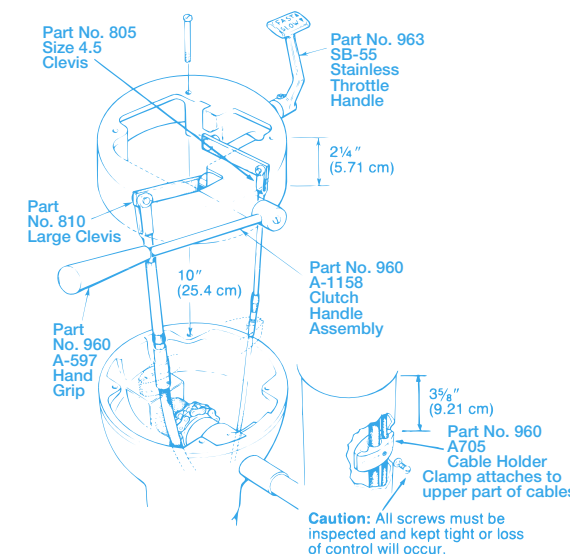

Installation Guidelines

- All Edson Dual Lever engine controls are designed to be used with only those engine transmissions having detents to locate and hold the transmission in gear.
- Lead cables under the deck using a minimum number of bends with a generous radius. The degree of bend in the cable, when all bends are added together, **should not exceed 270 degrees**. Tape or clamp to several structural members to reduce cable lost motion and prevent interference with sheaves and wire rope.
- Cables may be adjusted by screwing the clevises at the engine control or engine end in or out, or by attaching the clevis at a different position on the shift or throttle levers at the engine end.
- If engine vibration causes unwanted throttle movement, adjust throttle friction adjuster.
- Those on board must be familiar with the maintenance and operation of the controls. All screws must be kept tight and cotter pins properly secured.

Type Control	Edson Shift Cable Used	Edson Throttle Cable Used	Max. Clutch Cable Throw	Max. Throttle Cable Throw	Approx. Max. Operator Input for a Properly Adjusted Transmission
#751	#735	#734	3 3/4" (86 mm)	3" (76 mm)	15 to 20 lbs. (6.8 to 9 kg)
#870	#734	#734	3" (76 mm)	3" (76 mm)	5 to 10 lbs. (2.2 to 4.5 kg)
#816	#734	#734	3" (76 mm)	3" (76 mm)	10 to 15 lbs. (4.5 to 6.8 kg)

Note: Max. cable throw figures on using Edson's standard 4" (10.2 cm) Column Pedestal.



Tech Tip

How do I determine which Edson Pedestal I have?

Edson makes two sizes of Classic Pedestals: a 300 Series with 6-7/8" diameter top (often referred to as size 45, since they will hold a compass with a 4" or 5" card), and a 400 Series with 8" diameter top (often referred to as size 6, since they will hold a compass with a 6" card).

When ordering pedestal accessories, look for size 45 for 6-7/8" 300 Series Pedestals and size 6 for 400 Series 8" Pedestals.

#400, 402, 464 - 8" / 20.3cm Dia.
#334, 335, 336 - 6-7/8" / 17.4cm Dia.

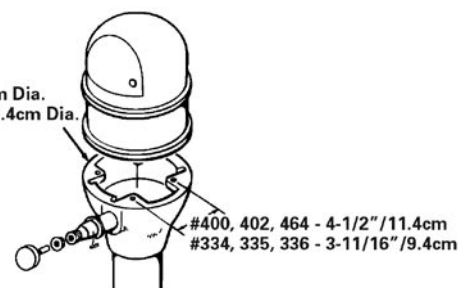

GO TO

See Page 41 for Engine Control Cables

Photo courtesy of Catalina Yachts



Catalina 320

Edson's Side-Mount Single-Lever Engine Control provides simple, safe, one-handed operation while maneuvering your boat under power. Mounted on the Pedestal with the choice of three different 1 1/2" diameter Stainless Pedestal Guard Pipes and a stainless Top Plate, it takes up virtually no additional cockpit space and incorporates positioning holes for quick mounting of any of Edson's Teak or Poly Cockpit Tables.

Features of the Control:

- Single-Lever operation of both the clutch and throttle.
- Comes complete with Morse SL3 Engine Control Mechanism.
- Neutral Lockout—throttle can be operated without engaging transmission.
- Positive detents for transmission.
- Constructed of the highest quality non-magnetic marine-grade materials.
- Cast Aluminum Housing with Glossy White Baked-on urethane finish—matches Edson Pedestals.
- Highly polished investment-cast 316 Stainless Handle.
- Type 316 Stainless Top Plate, Guard Pipes and Guard Feet Included.
- Mounts to the Edson Pedestal with choice of Three Different Pedestal Guard Pipes.
- Sized to fit 6-7/8" or 8" Edson Pedestal Bowls.
- Fits all Edson Pedestals Classic Style Pedestals with Thru-Shaft Brakes.
- Gasketed Housing—keeps moisture away from mechanism and cables.



Integrated Cockpit Table Positioning Holes allow easy mounting of Edson Teak or Poly Cockpit Tables without drilling.



GO TO
See Page 41 for Engine Control Cables

SIDE MOUNT SINGLE LEVER ENGINE CONTROL ORDERING GUIDE

To Fit Edson Pedestal	With 58" Straight Guard Order #	With 58" Angled Guard Order #	With 58" Offset Guard Order #
#336 (6-7/8" Dia. Pedestal Top)	1660-45C-58S	1660-45C-58A	1660-45C-58OS
#402, #464 (8" Dia. Pedestal Top)	1660-6C-58S	1660-6C-58A	1660-6C-58OS

NOTE: All sizes come complete with engine control mechanism, handle, housing, stainless top plate, guard pipe and feet. The installer furnishes the appropriate control cables. Not to be used with Atomic 4 or other hard to shift mechanical transmissions. Control must be used with Edson 1 1/2" Guards and Thru-Shaft Wheel Brake.

Stainless Engine Control Handles

Order these to upgrade your older Edson controls. Highly polished, marked "Fast-Slow" and "Fwd-Rev". They can be easily retrofitted onto existing Edson engine controls.

Throttle Handle – Order #963SB-55
Clutch Handle – Order #963PT-55



IMPORTANT

- These handles are only for Edson's Dual Lever Engine Controls.
- Older pedestals with 10-32 engine control shaft threads must be retapped to 1/4"-28 in order accept the mounting screws supplied with these handles.

Engine Control Cables

The proper engine control cables will have a dramatic effect on the performance of your engine control. Edson carries only premium high-efficiency cables that feature a coiled inner core that can take bends much better than solid core cables. Cables are not included with the engine controls because the length varies with each installation.

For lengths available see Price Page.

33 Series Throttle and Clutch Cable - Order #734 (Specify Length)
64 Series Clutch Cable - Order #735 (Specify Length)

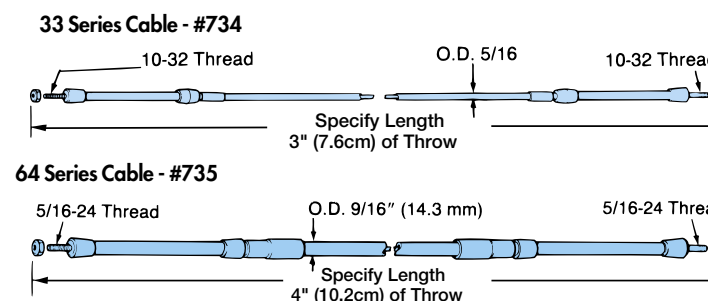

Bronze Engine Control Clevises

Each engine control is supplied with solid bronze clevises and brass clevis pins for the engine control end. Extra clevises for the engine must be ordered separately. #805-4.5 comes standard with #816 and #870 Controls. #810-225 accommodates 64 Series Cables and is included with #751 controls for the gear shift.

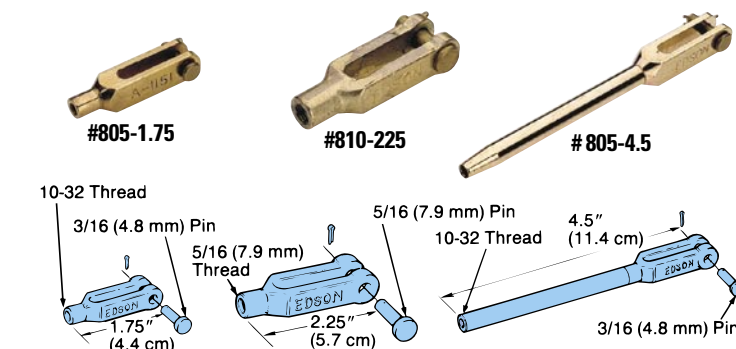

Engine Control Decal

A red decal on your engine controls provides you and your guests with instructions at a glance. It is supplied with all new controls. Order a replacement if yours has become unreadable. Works for all engine controls.

Order #960-A-1203

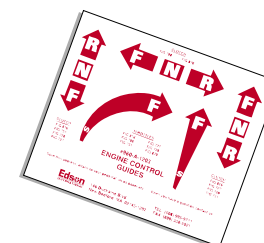

Clutch Travel Limiter

Standard on current #816ST-45 Engine Controls, can be added to older models to limit the travel of the clutch cable.

Order #914-45-2

Fig. 963 SB-55 Stainless Throttle Handle (supplied with 1/4"-28 stainless screw)

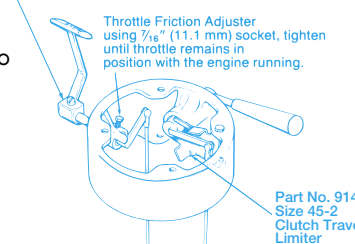

Part No. 914 Size 45-2 Clutch Travel Limiter

Pedestal Accessories

Pedestal Accessories